

TURBOMALT



CE EC Machinery Directive 2006/42/EC

Compliant with EN 12151 – machinery and plants for the preparation of concrete and mortar

**MIXER for traditional,
pre- or pre-mixed MORTAR, SCREED,
CONCRETE AND REINFORCED CONCRETE**

ADVANTAGES

- ✓ **Ease of use**
- ✓ **Speed of production**
- ✓ **Collapsible for transport**
- ✓ **Easy to clean**
- ✓ **Low maintenance**
- ✓ **Silent**
- ✓ **Available in a 220 Volt and three-phase 400 Volt version**

FIELDS OF APPLICATION

- Mortars for masonry and stucco applications.
- Screeds and substrates.
- Concrete and reinforced concrete.
- Fast curing concrete (with special augers).
- Glues and fillers.
- Ideal for:
 - small work sites.
 - apartment renovations.
 - buildings, even partially inhabited.

CLEANING AND MAINTENANCE

- **Cleaning:** just remove the auger and scrape the bottom of the tank. Wash the entire machine if necessary.
- **Maintenance:** regularly lubricate the mechanical parts and remove any encrusted product.



In the four operating positions and closed for transport.



Its compact size facilitates transport and use, even at small work sites.

MAIN TECHNICAL DATA

WEIGHT empty		110 kg
DIMENSIONS	collapsed (for transport)	150 x 60, H = 62 cm
	open (in use)	150 x 60, H = 120 cm
POWER	SINGLE PHASE 230 Volt	50 Hz, 4 A, IP 54 1,5 kW, 2 HP
	THREE PHASE 400 Volt	50 Hz, 9 A, IP 54 1,5 kW, 2 HP
Load capacity		100 litres
Speed		50 RPM

SPARE PARTS

- See the following page.

NOTES

- **Standard auger:** for MORTAR, not suitable for mixtures containing aggregates greater than 5 mm in size.
- **For aggregates greater than 5 mm in size:** purchase the special auger.
- Do not remove the safety devices or protective guards.
- Any tampering with the control panel or gear motor will nullify the warranty.

SPARE PARTS

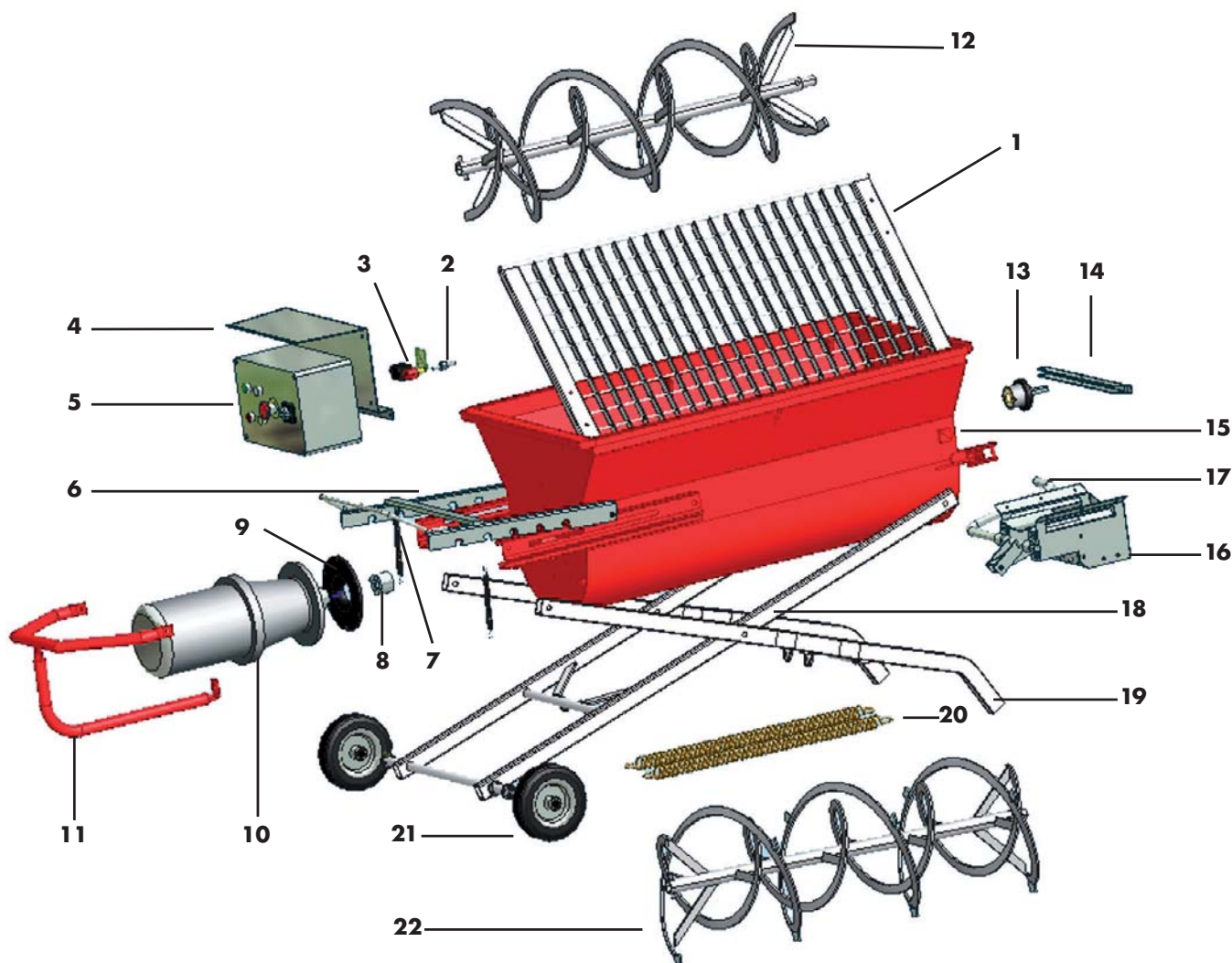

1 Upper safety cage	8201 EV	11 Gear motor protection section	8212 EV
2 Mechanical sensor pin	8224 EV	12 Auger for mortar	8213 EV
3 Mechanical safety pin with plate	8248 EV	13 Vulcolan unit	8214 EV
4 Electrical panel support plate	8203 EV	14 Vulcolan unit handle	8215 EV
5 Control panel 230 V single-phase	8204 EV	15 Mixing tank	8216 EV
Control panel 400 V three-phase	8205 EV	16 Discharge hatch unit	8217 EV
6 Mixing tank positioning bracket	8206 EV	17 Discharge hatch unit lever	8218 EV
7 Positioning bracket return springs	8207 EV	18 Support frame with wheels	8219 EV
8 Auger rotation coupling	8208 EV	19 Support frame with grip	8220 EV
9 Gear motor gasket flange (flange seal)	8209 EV	20 Support frame return springs	8221 EV
10 Gear motor 230 V single-phase	8210 EV	21 Wheel	8222 EV
Gear motor 400 V three-phase	8211 EV	22 Auger for special mixtures	8223 EV